



Larger Capacity, Less Maintenance

The CM8 is a continuous composting system — meaning all material is composted and collected in a single chamber. There's no need to swap chambers, unlike batch systems.

Perfect for large families or anyone seeking a low-effort, high-capacity composting toilet, the CM8 is ideal for off-grid homes, tiny houses, and remote walking trails.



Waterless



Low Maintenance



Sustainable



Odourless

How It Works

Engineered to maintain optimal aerobic conditions, it naturally transforms waste into nutrient-rich compost — no plumbing, water, or costly excavation required.

Fan

Encourages airflow to bring oxygen to the microorganisms and to evaporate excess liquids.

Maintenance Door

For inspection and to level out the pile with a rake.

Compost Door

Can be buried up to this level

Baffle

The baffle separates the composting pile from the access door so you only handle composted material — never fresh waste.

Leachate Drain or Zero Discharge

Drain excess liquid into the ground or recycle it without discharge.

Proudly Australian Made

Certified to the highest Australian and New Zealand standards — quality you can trust, made right here in Australia.



Airflow

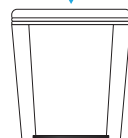

600mm

Fresh Waste to Compost

As waste composts, it reduces in volume.

Sloped floor

Allows the composted material on the bottom to move towards the front for collection.

Drainage Holes & Wicks

Optimises the moisture level of the pile.



SPECIFICATIONS

Capacity	6-12 people
Approx. Uses	Daily: 20 visits Annually: 8,000 visits
Volume	850L
Dimensions	1500L x 1200W x 1300H mm
Clearance - If partially buried	Min. 850mm underfloor
Clearance - If above ground	Min. 1350mm underfloor
Bury depth	Max. 550mm
Max. Fixtures	1 pedestal
Included kits	Starter pack, vent & drain kit
Power	12V 5W Fan
Warranty	10 years for moulded parts



PEDESTAL OPTIONS



Porcelain Pandora
Perfect for narrow spaces



Porcelain Palisade
Modern, elegant design



Porcelain Pasadero
Urine diverting

HOW TO START



Add a **starter bed** of bulking agent up to the underside of the baffle. Slightly dampen with water.

Recommended:

- Pine woodshavings
- Hemp bedding

Not recommended:

- Fine sawdust
- Cypress, cedar or eucalyptus woodshavings
- Sugar cane mulch



After about 14 days of use or 20 visits, add about a ¼ cup of **microbes** mixed with warm water.

Repeat after 14 days of use or 40 visits.

HOW TO OPERATE

After every **liquid deposit**, simply close the lid.

After every **solid deposit**, do as shown:

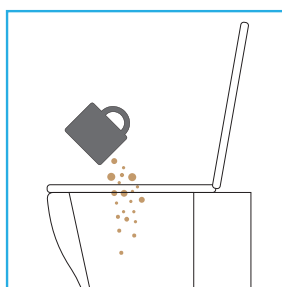

1. Add a generous cup of bulking agent

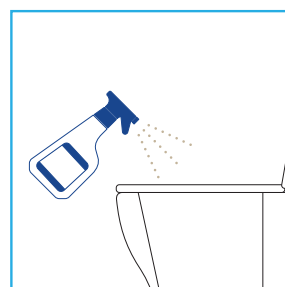

2. Spray enzyme solution around the pedestal bowl

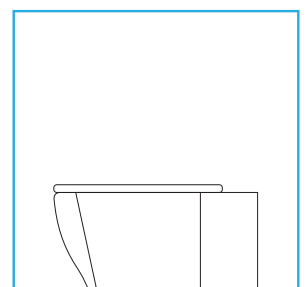

3. Close the lid